

FLOOR PLAN SCALE 1/16" = 1'-0"

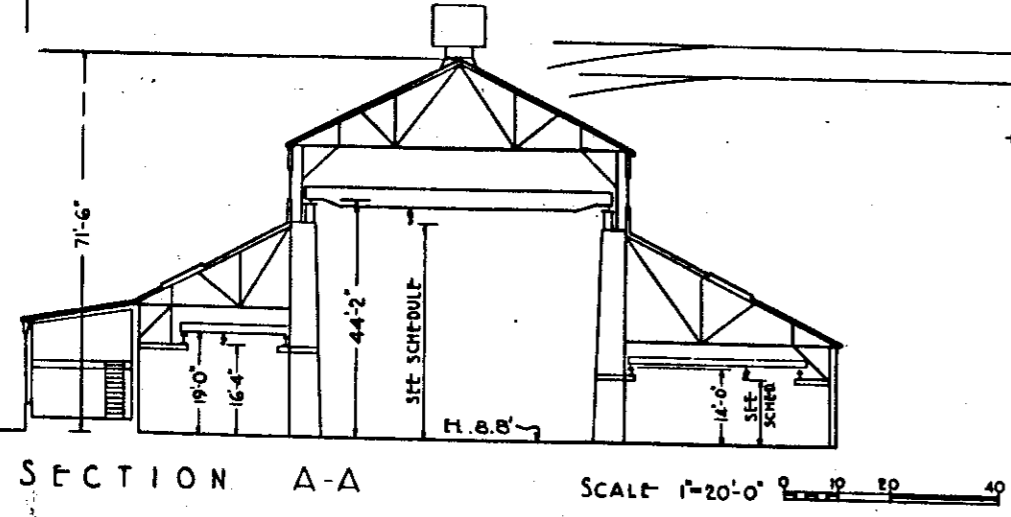

SECTION A-A SCALE 1" = 20'-0"

CRANE DATA

LOC. NO.	DESCRIPTION	HOOK HT.
C1	50 TON AUX.	37'-3"
C2	3 " CHAIN HOIST	36'-3"
C3	5 " SHEP. NILES	13'-0"
C4	5 " " " "	13'-0"
C5	5 " " " "	18'-0"
C6	3 " SHEP. NILES	
C7	75 " MAIN LIFT	38'-6"
C7	10 " AUX.	41'-8"
C8	3 " FLEC.	16'-4"

GENERAL DATA

BUILDING OWNED BY	D.S.
ERECTED	1898 - 1937
LENGTH	350'-8 1/2"
WIDTH	182'-11 1/2"
HEIGHT	71'-6"
AREA - SQ. FEET	53,042
FLOOR AREA	51,910
CUBIC CONTENTS - CUBIC FEET	1,939,830
BUILDING MATERIALS	STEEL, CONC., BRICK, CORR. IRON & WOOD
BUILDING CONSTRUCTION	FIRST CLASS
FLOORING	CONC.
ROOFING	CORR. IRON
SPRINKLER SYSTEM	NONE

2	DO ALL BAND SAW	36453664	190
3			
4	BENDING BLOCKS		190
5	BENDING BLOCKS		190
6			
7			
8			
9			
10			
11			
12			
13			
14	BENDING BLOCKS		195
15			
16	AMERICAN WIZARD	65575	194
17	KLING PYRAMID ROLL	2123	190
18	BRIDGEPORT DEL. GRINDER		191
19	FLANGING PRESS-350 TON	1537	191
20	ELEM. C. FRAME PRESS	12228	190
21	WALLACE SAW		
22	KLING Bros. Horiz. PUNCH	2193	189
23	KLING Bros. PUNCH	2256	190
24			
25			
26			
27			
28	CINCINNATI SHEAR	15310	
29			
30			
31	FURNACE		
32			
33			
34			

ELECTRIC SHOP - NE CORNER

37	PEXTO CUTTER		
38	RIGID 2" PIPE THREADER		
39	MECHANICS TABLE		
40	EQUIPT. CONTAINER		
41	DELTA ABRASIVE SAW		
42	ROCKFORD PUNCH PRESS		
43	BANDING TABLE		
44	STANDARD GRINDER		
45	BUFFALO PUNCH PRESS		
46	DELTA BAND SAW		
47	MATERIAL RACK		
48	AMERICAN HOPE WIZARD		
49	DRILL BIT CABINET		
50	(3) LABOR PRESSES		
51	ROCKWELL/DELTA PRESS		

* TRANSFERRED FROM QUINCY YARD.

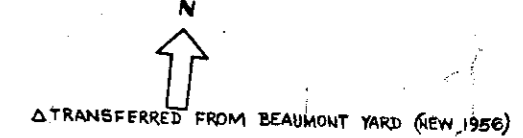

KEY PLAN SHOWING ERECTION DATES

1898	1916
1948	1918 1937 1952